

# KESWICK

VENEER / LAMINATE COLLECTION

DESIGN CHANGES EVERYTHING®



7990

# K E S W I C K

7990 / VENEER / LAMINATE



*Traditional Styling - Decorative wood accent mouldings, recessed modesty panels, and decorative, plated brass, swinging bail hardware come together to create a rich traditional look.*

*Top surfaces are detailed with decorative cherry inlay veneer and walnut banding with a polyurethane topcoat.*

*Construction - The Keswick Collection consists of wood, wood veneers and wood materials featuring solid wood bases, shaped mouldings and pilasters with an English Cherry finish. Tops are constructed of wood and veneer materials or HPL tops. Veneer tops feature decorative inlaid cherry veneers bordered by a walnut banding. A polyurethane topcoat provides protection against discoloration from sunlight. HPL tops are straight grained.*

*Cases feature mortise and tenon construction with wood cleats, glue, screws, staples and threaded inserts with bolts. Drawers are constructed with solid wood sides and backs, veneer fronts with veneer edgebands and three-ply veneer bottoms. Drawer interiors are stained and sealed and showcase dovetail construction.*

Keswick is the majestic leader in traditional office environments. An impeccable English Cherry finish on cherry veneer with veneer tops and/or HPL tops and refined styling in solid wood pilasters and mouldings offer unmatched luxury. Desks feature felt-lined center and top drawers and central locking. Pull-out writing shelves offer extra work area at your fingertips.



3

"U" Desk is shown with DMI's optional Tower CPU Stall.



*Function - All drawers are suspended on fully extending, metal, ball-bearing slides allowing easy access to the entire drawer. Box drawers have a 100 lb. load bearing rating. File drawers have a 150 lb. load bearing rating and are equipped with metal rods to accommodate front-to-back letter or side-to-side legal sized hanging file folders.*

*All cases are equipped with levelers to adjust for less than even flooring.*

*Computer applicable furniture feature grommets or other openings that facilitate neat and easy management of computer cables.*

*Desks, credenzas, and returns include convenient pull-out writing boards for an expanded work surface.*



# K E S W I C K

7990 / VENEER / LAMINATE





# K E S W I C K

7990 / VENEER / LAMINATE



**EXECUTIVE DESK**

**7990-36**  
W72 D36 H30



**EXECUTIVE DESK**

**7990-36HPL**  
W72 D36 H30



**EXECUTIVE DESK**

**7990-30**  
W66 D30 H30



**EXECUTIVE DESK**

**7990-30HPL**  
W66 D30 H30

- Pull-out writing board / box / locking box / locking file drawer per pedestal.
- Center drawer with a double pencil tray.



**TABLE DESK**

**7990-88 / 7990-88HPL**  
W72 D36 H30

- Two pull-out writing boards.
- Three drawers.



**EXECUTIVE CREDENZA**

**7990-20 / 7990-20HPL**  
W72 D24 H30

- Pull-out writing board / box / box / file drawer per pedestal.
- Center drawer with a drop-front.
- Storage cabinet with one adjustable shelf.



**KNEEHOLE CREDENZA**

**7990-21 / 7990-21HPL**  
W72 D24 H30

- Pull-out writing board / box / locking box / locking file drawer per pedestal.
- Drop-front keyboard drawer.
- Cable accessible.

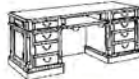

**COMPUTER CREDENZA**

**7990-22 / 7990-22HPL**  
W72 D24 H30

- Pull-out writing board / box / locking box / locking file drawer in the left pedestal.
- Pull-out writing board, box drawer and computer cabinet in the right pedestal.
- Drop-front keyboard drawer.
- Cable accessible.



**LATERAL FILE CREDENZA**

**7990-26 / 7990-26HPL**  
W72 D24 H30

- Four locking file drawers.
- Equipped to accept front-to-back letter and / or side-to-side legal hanging files.



**86" RIGHT EXECUTIVE "L" DESK**

**7990-48 / 7990-48HPL**  
W66 D78 H30

- Consists of:
- 470/-470HPL Left Single Pedestal Desk W66 D30 H30
  - 579/-579HPL Right Single Pedestal Return W48 D24 H30

**ALSO AVAILABLE:**  
**66" LEFT EXECUTIVE "L" DESK**

- 7990-49 / 7990-49HPL**
- Consists of:
- 480/-480HPL Right Single Pedestal Desk
  - 589/-589HPL Left Single Pedestal Return
- Pull-out writing board / box with pencil tray / locking box with dividers / locking file drawer per pedestal.
  - Center drawer with pencil tray on the single pedestal desk.
  - Cable accessible.



**72" RIGHT EXECUTIVE "L" DESK**

**7990-57 / 7990-57HPL**  
W72 D84 H30

- Consists of:
- 570/-570HPL Left Single Pedestal Desk W72 D36 H30
  - 579/-579HPL Right Single Pedestal Return W48 D24 H30

**ALSO AVAILABLE:**  
**72" LEFT EXECUTIVE "L" DESK**

- 7990-58 / 7990-58HPL**
- Consists of:
- 580/-580HPL Right Single Pedestal Desk
  - 589/-589HPL Left Single Pedestal Return

- Pull-out writing board / box / locking box / locking file drawer per pedestal.
- Center drawer with a double pencil tray on the single pedestal desk.
- Cable accessible.



**RIGHT EXECUTIVE "U" DESK**

**7990-37 / 7990-37HPL**  
W72 D110 H30

- Consists of:
- 570/-570HPL Left Single Pedestal Desk W72 D36 H30
  - 577/-577HPL Right Single Pedestal Credenza W72 D24 H30
  - 59/-59HPL "U" Bridge, W50 D24 H30

**ALSO AVAILABLE:**  
**LEFT EXECUTIVE "U" DESK**

- 7990-38 / 7990-38HPL**
- Consists of:
- 580/-580HPL Right Single Pedestal Desk
  - 588/-588HPL Left Single Pedestal Credenza
  - 59/-59HPL "U" Bridge
- Pull-out writing board / box / locking box / locking file drawer per pedestal.
  - Center drawer with a double pencil tray on the single pedestal desk.
  - Drop-front pull-out keyboard drawer on the credenza.
  - Cable accessible.



**RIGHT "L" RECEPTION DESK**

**7990-66 / 7990-66HPL**  
W72 D84 H44

Consists of:

- 507/-507HPL Left Single Pedestal Desk  
W72 D36 H30
- 579/-579HPL Right Single Pedestal Return  
W48 D24 H30
- 524/-524HPL Desk Riser, W71.5 D12 H14
- 525/-525HPL Return Riser, W72 D12 H14

**ALSO AVAILABLE:**

**LEFT "L" RECEPTION DESK**

**7990-67 / 7990-67HPL**

Consists of:

- 508/-508HPL Right Single Pedestal Desk
- 589/-589HPL Left Single Pedestal Return
- 526/-526HPL Desk Riser
- 527/-527HPL Return Riser

- Pull-out writing board / box with pencil tray / locking box with dividers / locking file drawer per pedestal.
- Center drawer with pencil tray on the single pedestal desk.
- Cable accessible.



**RIGHT "U" RECEPTION DESK**

**7990-68 / 7990-68HPL**  
W72 D110 H44

Consists of:

- 507/-507HPL Left Single Pedestal Desk  
W72 D36 H30
- 577/-577HPL Right Single Pedestal Credenza  
W72 D24 H30
- 59/-59HPL "U" Bridge  
W50 D24 H30
- 521/-521HPL Desk Riser  
W71.5 D12 H14
- 522/-522HPL Credenza Riser  
W71.5 D12 H14
- 523/-523HPL "U" Bridge Riser  
W85.5 D12 H14

**ALSO AVAILABLE:**

**LEFT "U" RECEPTION DESK**

**7990-69 / 7990-69HPL**

Consists of:

- 508/-508HPL Right Single Pedestal Desk
- 588/-588HPL Left Single Pedestal Credenza
- 59/-59HPL "U" Bridge
- 521/-521HPL Desk Riser
- 522/-522HPL Credenza Riser
- 523/-523HPL "U" Bridge Riser

- Pull-out writing board / box with pencil tray / locking box with dividers / locking file drawer per pedestal.
- Center drawer with pencil tray on the single pedestal desk.
- Drop-front, pull-out keyboard tray on the credenza.
- Cable accessible.



**ORGANIZER**

**7990-53**  
W13 D9 H13

- Divided storage.
- Can be used horizontally or vertically.
- Use with Reception Desk Risers.



**OVERHEAD STORAGE WITH WIRE MESH DOORS**

**7990-41**  
W36 D15 H50

- Two adjustable shelves.
- Use with -14 or -16.



**OVERHEAD STORAGE WITH LEADED GLASS DOORS**

**7990-42**  
W36 D15 H50

- Two adjustable shelves.
- Use with -14 or -16.



**OPEN OVERHEAD STORAGE**

**7990-401**  
W36 D16 H50

- Two adjustable shelves.
- Use with -14 or -16.



**OVERHEAD STORAGE WITH WIRE MESH DOORS**

**7990-463**  
W72.25 D14 H52.75

- Two, two-door cabinets, each with two adjustable shelves.
- Use with -20, -20HPL, -21, -21HPL, -22, -22HPL, -26, -26HPL, -577, -577HPL, -588, -588HPL.

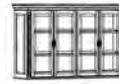

**OVERHEAD STORAGE WITH LEADED GLASS DOORS**

**7990-464**  
W71.75 D16 H50

- Two, two-door cabinets, each with two adjustable shelves.
- Use with -20, -20HPL, -21, -21HPL, -22, -22HPL, -26, -26HPL, -577, -577HPL, -588, -588HPL.



**OVERHEAD STORAGE**

**7990-62**  
W72 D15 H50

- Beveled glass doors.
- Two cabinets, each with two adjustable shelves.
- Center fixed shelf; center adjustable shelf.
- 19" vertical clearance for a monitor.
- 18" task light.
- Cable accessible.
- Use with -20, -20HPL, -21, -21HPL, -22, -22HPL, -26, -26HPL, -577, -577HPL, -588, -588HPL.



**EXECUTIVE OVERHEAD STORAGE WITH WIRE MESH DOORS**

**7990-63**  
W72 D15 H50

- Center fixed shelf.
- Center, wood framed, adjustable glass shelf.
- Two cabinets, each with two adjustable shelves.
- Three accent lights; one task light.
- 19" vertical clearance for a monitor.
- Use with -20, -20HPL, -21, -21HPL, -22, -22HPL, -26, -26HPL, -577, -577HPL, -588, -588HPL.



**EXECUTIVE OVERHEAD STORAGE WITH LEADED GLASS DOORS**

**7990-64**  
W72 D15 H50

- Center fixed shelf.
- Center, wood framed, adjustable glass shelf.
- Two cabinets, each with two adjustable shelves.
- Three accent lights; one task light.
- 19" vertical clearance for a monitor.
- Use with -20, -20HPL, -21, -21HPL, -22, -22HPL, -26, -26HPL, -577, -577HPL, -588, -588HPL.



# K E S W I C K

7990 / VENEER / LAMINATE



### LATERAL FILE

**7990-16 / 7990-16HPL**  
W36 D24 H30

- Two individually locking drawers.
- Equipped to accept letter front-to-back and / or side-to-side hanging files or legal side-to-side hanging files.
- Anti-tip device.



### FOUR DRAWER LATERAL FILE

**7990-17 / 7990-17HPL**  
W36 D24 H54

- Four individually locking file drawers.
- Equipped to accept letter front-to-back and / or side-to-side hanging files or legal side-to-side hanging files.
- Anti-tip device.



### LATERAL FILE STORAGE UNIT

**7990-07**  
W40 D24 H80

Consists of:  
-071 Base  
-072 Top

- Two locking lateral file drawers.
- Two-door storage cabinet with two adjustable shelves.
- Anti-tip device.



### EXECUTIVE TWO-DOOR CABINET

**7990-14**  
W36 D24 H30

- Storage cabinet with one adjustable shelf.



### MEDIA CENTER CABINET

**7990-04**  
W54 D24 H82

Consists of:  
-041 Base  
-042 Top

- Top cabinet has pocket doors; 42 x 21.25 x 36.25 compartment that is cable accessible; top located shelf that is cable accessible; cable ready harness with electrical outlet; slide-out back panel.
- Bottom cabinet has two adjustable shelves and is cable accessible.



### DOUBLE DOOR WARDROBE

**7990-06**  
W44 D24 H78

- Ten adjustable shelves.
- Hanger rod.



### SINGLE DOOR WARDROBE

**7990-05**  
W24 D24 H78

- Five adjustable shelves and one fixed shelf.
- Removable hanger rod.



### BOOKCASE

**7990-09**  
W32 D15 H72

- Two adjustable shelves.
- Storage cabinet.



### OPEN BOOKCASE

**7990-108**  
W32 D16 H80

- Use with -118 and -128 to form a bookcase wall
- Two fixed shelves; four adjustable shelves.



### LEFT HAND FACING BOOKCASE

**7990-118**  
W33.75 D16 H80

- Use with -108 and -128 to form a bookcase wall
- Two fixed shelves; four adjustable shelves.



### RIGHT HAND FACING BOOKCASE

**7990-128**  
W33.75 D16 H80

- Use with -108 and -118 to form a bookcase wall
- Two fixed shelves; four adjustable shelves.



### BUFFET

**7990-25BC**  
W66 D24 H36

- Two, felt-lined fully extending drawers.
- One drawer contains a silverware holder.
- Two cabinets, each with an adjustable shelf.
- Heavy duty locking casters.



### TWO-DOOR BUFFET

**7990-26BC**  
W38 D24 H36

- Two, felt-lined fully extending drawers.
- Cabinet with an adjustable shelf.
- Heavy duty locking casters.







**42" ROUND QUEEN ANNE CONFERENCE TABLE**

**7990-89 / 7990-89HPL**  
42" diameter x 30" height  
Consists of:  
-011/-011HPL 42" Round Top  
-002 Queen Anne Base

**ALSO AVAILABLE:**

**48" ROUND QUEEN ANNE CONFERENCE TABLE**  
**7990-90 / 7990-90HPL**  
48" diameter x 30" height  
Consists of:  
-016/-016HPL 48" Round Top  
-002 Queen Anne Base



**8' RECTANGULAR CONFERENCE TABLE WITH TWIN SLAB END BASES**

**7990-94**  
W96 D48 H30  
Consists of:  
-004 8' Rectangular Top  
-007 Slab End Base (set)



**10' BOAT TOP CONFERENCE TABLE**

**7990-99**  
W120 D48 H30  
Consists of:  
-005 Two Piece 10' Boat Shaped Top  
-007 Slab End Bases (set)



**12' BOAT TOP CONFERENCE TABLE**

**7990-97**  
W144 D48 H30  
Consists of:  
-006 Two Piece 12' Boat Shaped Top  
-007 Slab End Base (set)  
-008 Slab Center Base



**SOFA/CONSOLE TABLE**

**7990-82**  
W48 D16 H28



**COFFEE TABLE**

**7990-40**  
W48 D24 H18



**END TABLE**

**7990-10**  
W24 D24 H24



**ROLL ARM EXECUTIVE CHAIR with NAIL TRIM**

**6840-1105 - Black Leather**  
**6840-1305 - Burgundy Leather**  
W29 D28 H48-51

- Genuine leather upholstery.
- Five star base with hooded casters.
- Swivel-tilt mechanism.
- Gas lift.



**GUEST CHAIR**

**6855-2105 - Soft Gold Fabric Cover**  
**6855-2205 - Burgundy Fabric Cover**  
W25 D26 H34

- English Cherry frame.



**PRESENTATION BOARD**

**7990-650**  
Open: W96 D4.75 H49  
Closed: W48 D4.75 H49

- Features a marker board and a tack board on the interior of each door.

# K E S W I C K

7990 / VENEER / LAMINATE

## EXPANDABLE TABLES PROGRAM



7990 (English Cherry Finish)

### FEATURES:

- Each top has a pre-installed grommet.
- Tables constructed of veneer, wood solids and wood product. Tops feature decorative marquetry cherry veneers bordered by walnut veneer banding protected with a UV top coat resisting scratches, marring and abrasion.
- Included mending plates ensure proper top alignment and secure assembly (1).
- Each base has six adjustable levelers that also assist in correct alignment and assembly.
- Designed with rails providing stability, adding style and helping to conceal the functional wire management troughs (2).
- Wire management troughs or trays provide aesthetically pleasing means to safely manage cables (3).
- Base component designed with cable opening at the top (4) and vertical channel within the base to guide cables out through bottom of the base.
- The cable opening in the top components are also positioned and sized to facilitate the installation of optional data ports/power centers (4).

### BASIC COMPONENTS

60" LEFT AND RIGHT SECTION EXPANDABLE CONFERENCE TABLE TOPS

7990-9030

48" LEFT & RIGHT SECTION EXPANDABLE CONFERENCE TABLE TOPS

7990-9031

48" CENTER SECTION EXPANDABLE CONFERENCE TABLE TOP WITH 44" RAILS

7990-9032

CONFERENCE TABLE BASE (1)

7990-9033

52" RAIL SET FOR 8' CONFERENCE TABLE

7990-9034

48" RAIL SET FOR LEFT & RIGHT 48" SECTION TOPS

7990-9035

60.5" RAIL SET FOR LEFT & RIGHT 60" TOPS

7990-9037

76" RAIL SET FOR 10' TABLE

7990-9038



KESWICK EXPANDABLE TABLES (Continued)



**8' EXPANDABLE  
CONFERENCE TABLE**

**7990-96EX**  
W96 D48 H30

Consists of:  
-9031 Left & Right Tops  
-9033 Bases (2 needed)  
-9034 Rail Set for 9031

**10' EXPANDABLE  
CONFERENCE TABLE**

**7990-120EX**  
W120 D48 H30

Consists of:  
-9030 Left & Right Tops  
-9033 Bases (2 Needed)  
-9038 Rail Set for 10' Table

**12' EXPANDABLE  
CONFERENCE TABLE**

**7990-144EX**  
W144 D48 H30

Consists of:  
-9031 Left & Right Tops  
-9032 Center Top & Rails  
-9033 Bases (3 Needed)  
-9035 Rail Set for 9031 (2 Needed)

**14' EXPANDABLE  
CONFERENCE TABLE**

**7990-168EX**  
W168 D48 H30

Consists of:  
-9030 Left & Right Tops  
-9032 Center Top & Rails  
-9033 Bases (3 Needed)  
-9037 Rail Set for 9030 (2 Needed)

**16' EXPANDABLE  
CONFERENCE TABLE**

**7990-192EX**  
W192 D48 H30

Consists of:  
-9031 Left & Right Tops  
-9032 Center Top & Rails (2 needed)  
-9033 Bases (4 Needed)  
-9035 Rail Set for 9031 (2 Needed)

**18' EXPANDABLE  
CONFERENCE TABLE**

**7990-216EX**  
W216 D48 H30

Consists of:  
-9030 Left & Right Tops  
-9032 Center Top & Rails (2 Needed)  
-9033 Bases (4 Needed)  
-9037 Rail Set for 9030 (2 Needed)

**20' EXPANDABLE  
CONFERENCE TABLE**

**7990-240EX**  
W240 D48 H30

Consists of:  
-9031 Left & Right Tops  
-9032 Center Top & Rails (3 Needed)  
-9033 Bases (5 Needed)  
-9035 Rail Set for 9031 (2 Needed)

**22' EXPANDABLE  
CONFERENCE TABLE**

**7990-264EX**  
W264 D48 H30

Consists of:  
-9030 Left & Right Tops  
-9032 Center Top & Rails (3 Needed)  
-9033 Bases (5 Needed)  
-9037 Rail Set for 9030 (2 Needed)